

# KOMBO SD<sup>+</sup> & SDC<sup>+</sup> SERIES

**AUTOMATIC CAD-CAM  
CUTTING SYSTEM**

# KOMBO SERIES WITH SEEKER SYSTEM SIMPLICITY AT A GLANCE

The complete range of **KOMBO** digital plotters for automatic cutting and finishing has been specifically engineered to meet the latest requirements, in the **digital printing, cardboard, sign, and billboard industries**.

More than 25 years of Italian manufacturing experience and technological innovation are at the foundations of **Elitron's** multi-function systems, equipped with **multi-tools for cutting, milling, creasing, and engraving**.

Suitable for sampling, short to medium and complex production runs, the Kombo systems offer maximum **versatility**. Excelling in terms of **productivity** and **automation** to meet and often anticipate market demands. Only **KOMBO** systems can be equipped with the **Seeker System™**, an intelligent vision system which automatically recognises printed images and reference marks.

This **exclusive Elitron patent** significantly reduces production times and cuts the cost of the entire production process. Cutting-edge safety devices are activated automatically should there be any obstacle during production in order to guarantee maximum operator safety at all times.

## MAIN CHARACTERISTICS

5 multi-tool head for cutting, creasing and milling materials  
**up to 120 mm**

### Automatic tool presetting

Integrated, patented vision system **Seeker System™** to automatically recognise printed images and reference marks

Cuts **different materials during the same working session**, without changing tools

Working **speed** of up to **102 m/min, acceleration 1,4 G**

**Video Projection System** to **optimise material yield**, and re-use otherwise waste materials

**High precision** movement mechanisms

Working area divided into 40 concentrated vacuum sectors, for **maximum material adhesion on the working surface**

**Solid steel** structure

Possibility to configure **two working areas**

Compatible with **Industry 4.0**

KOMBO SDC+



WORKING AREA  
3200 x 2000 MM

KOMBO is also available with a **conveyor driven working area**.

This can be equipped with:

- **feeding system** for roll materials
- **holding clamp** to ensure material advancement, even of the most critical materials
- **synchronized unloading table** to facilitate the collection of finished materials.

# Kombo SERIES - Freedom at work

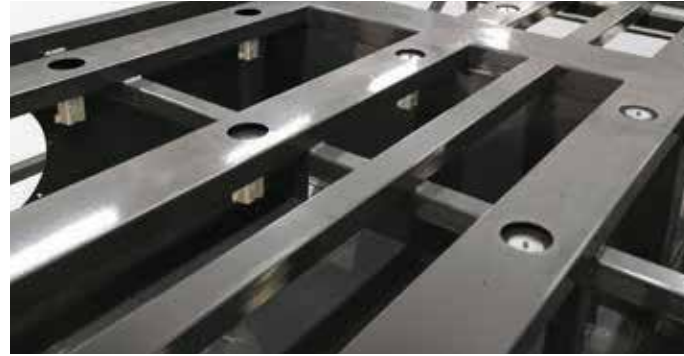

## Machine structure

**Synonymous with reliability that lasts the test of time.**

The machine structure is made of a single block of solid steel. The strong gantry ensures stability during production, with no flexing or vibrating. **Design and technology 100% Made in Italy.**

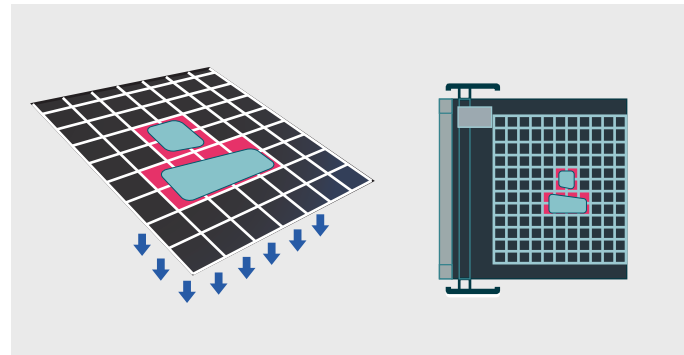

## Vacuum table

**Perfect material adhesion for a high-quality finish.**

The cutting area is divided into **40 sectors**, automatically activated and deactivated where material is detected. The vacuum power is then only concentrated where necessary.



## Multi-tool head

**Maximum flexibility** during production, using the multi-tool cutting head equipped **with up to 5 tools simultaneously**. Furthermore, an impressive software feature allows **different materials to be worked during the same production session**.

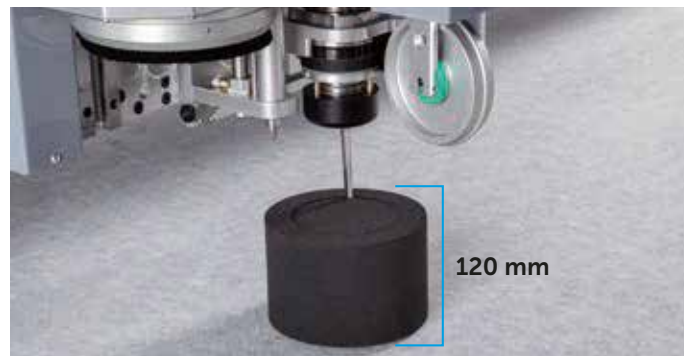

## Varying heights

**Fast and efficient** response to a multitude of customer job requests. Extremely **versatile**, and able to process **materials up to 120 mm high** using the quick tool-setting function to set the material height.



## 3D Milling

Using eliCNCInterface software, which works on **3 interpolated axes (x,y,z)**, the **3D ISO file is imported**, read and converted into a cutting path. This system enables fast, precise, and smooth 3D milling of multi-materials such as PVC, wood, foam, UREOL, etc.



## Seeker System PRO

Exclusive Elitron patent

**Fully automatic system to recognise printed images** wherever they are positioned on the working area.

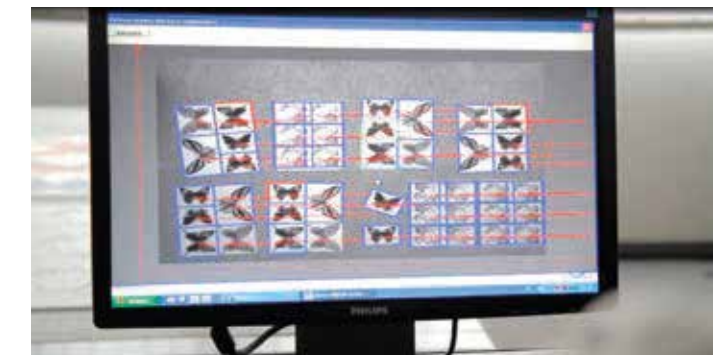

## Stressless Working Technology

Yield optimisation using the new **Stressless Working Technology** that projects **virtual dies** onto the material. The operation is extremely fast and safe for the operator, with **considerable material and cost savings** thanks to the possibility of reusing otherwise waste materials.

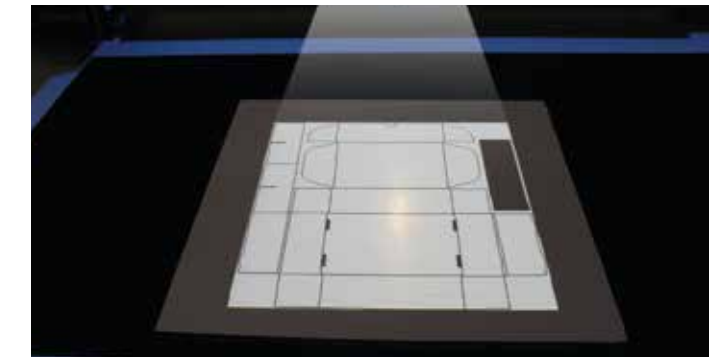

## High performance motors

The **PLUS** version is the **fastest**, for **high performance and increased productivity**, at up to 102 m/min with 1.4 G acceleration.



# Seeker System

Cut processing times



Innovative vision system that independently identifies the position of print reference points on materials. This technology **enables the cutting path to be precisely positioned on the printed material**. A sensor system housed inside the cutting head recognises print reference points and uses them to synchronize and manage the cutting path.

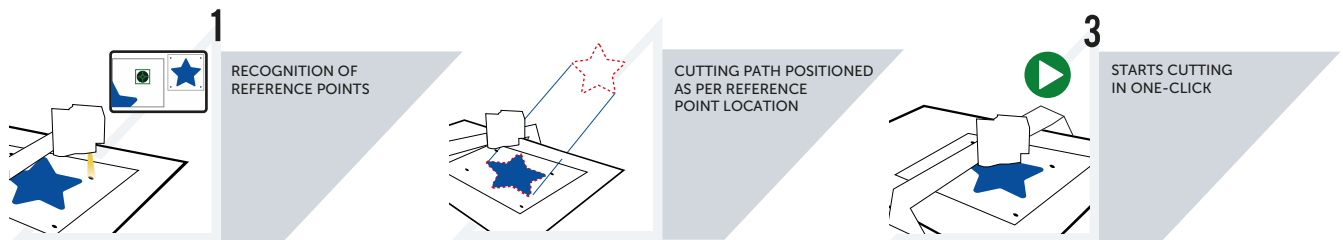

## Seeker PRO increases productivity during every single working cycle

A dual camera system with powerful image processing software automatically scans the working area, **recognises printed images and automatically loads the corresponding pre-saved cutting files.**

**Seeker PRO can process different materials simultaneously (PVC foam, vinyl, composite materials, etc.), without the sheets having to be placed in any particular position on the working area.** The operator can therefore complete more jobs efficiently, whilst carry out preparatory activities at the same time as the machine processes the current job.

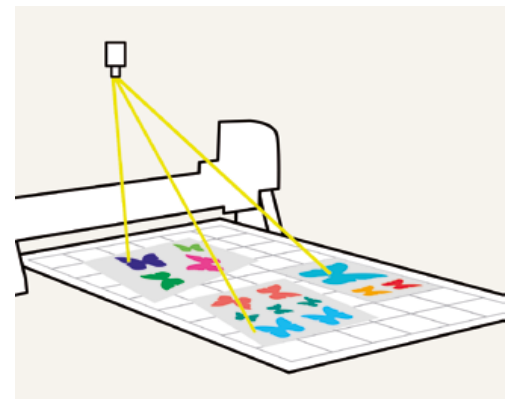

## Setup

After selecting the image to be processed, the second camera installed on the cutting head **searches and automatically detects the position of the printing reference points**, verifies the **alignment** between the cutting path and the printed image and **corrects any deformation and distortion.**



## TOOLS A HEAD OF VERSATILITY

A complete range of easy-to-configure tools, depending upon the material to be processed, with an automatic pre-setting system.

- Cutting head with fixed or oscillating knife, electric and/or pneumatic
- 1 kW Electro spindle milling module with manual or semi-automatic tool change
- 3 kW Electro spindle milling module with semi-automatic tool change
- 3 kW Electro spindle milling module with 4-position fully automatic tool change
- Creasing wheel kit with different diameters and profiles
- Kiss-cutting (half cut)
- V-cut, 45° knife (other cutting angles also available)
- Cut & Crease knife
- Circular knife
- Pen module
- Laser pointer



Optional NEW multi-tool head with **knife and milling modules on independent axes. 3kW, 50,000 rpm**, electro spindle milling modul with integrated **4-position fully automatic** tool change .

## MATERIALS FLEXIBILITY TO SUPPORT YOU

Processes a wide range of materials with extreme precision.

- |   |  |
|---|--|
| <ul style="list-style-type: none"> <li>• Forex</li> <li>• Dibond</li> <li>• PVC</li> <li>• Plastics</li> <li>• Films</li> <li>• Textiles</li> </ul> | <ul style="list-style-type: none"> <li>• Re-board</li> <li>• Paper and cardboard</li> <li>• Corrugated cardboard</li> <li>• Foams up to 120 mm</li> </ul> <p>... and many more</p> |
|---|--|



## APPLICATIONS MATERIAL TAKES SHAPE

Limitless productivity. The extraordinary flexibility of the KOMBO range allows you to satisfy a wide range of requests from your customers.

- |   |   |
|---|---|
| <ul style="list-style-type: none"> <li>• Packaging</li> <li>• POS displays</li> <li>• Transparent containers</li> <li>• Advertising banners</li> <li>• Folders</li> <li>• Binders</li> <li>• Boxes</li> </ul> | <ul style="list-style-type: none"> <li>• Embossed logos</li> <li>• Promotional trade fair stand panels</li> <li>• Promotional flags</li> <li>• Brochure holders</li> <li>... and many more</li> </ul> |
|---|---|



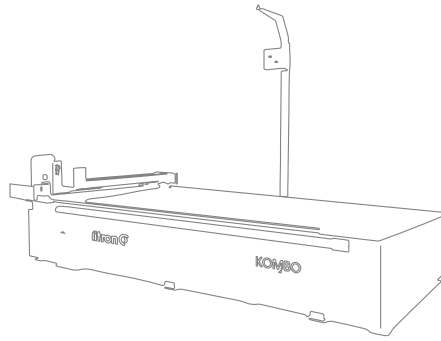

## TECHNICAL INFORMATION

	KOMBO SD+ 16.20		KOMBO SD+ 32.20 KOMBO SDC+ 32.20		KOMBO SD+ 32.16 KOMBO SDC+ 32.16		KOMBO SD+ 40.25	
	Standard	Video projection*	Standard	Video projection*	Standard	Video projection*	Standard	Video projection*
<b>Version</b>								
<b>Working area (mm)</b>	1600 x 2000		3200 x 2000		3200 x 1600		4000 x 2500	
<b>Vacuum sectors on working area (N)</b>	20		40		32		60	
<b>Conveyor model availability</b>	-		Yes		Yes		-	
<b>Machine dimensions fixed table (mm)</b>	2850 x 2400	2850 x 2500	4350 x 3000		4350 x 2600		5260 x 3450	6180 x 6450
<b>Machine dimensions conveyor table (mm)</b>	-		4500 x 3000		4500 x 2600		-	
<b>Machine height (mm)</b>	1600	2650**	1500	3500***	1500	3500***	1460	2900***
<b>Working area height (mm)</b>	900		900		900		900	
<b>Machine weight fixed table (kg)</b>	2100	2300	2700	3000	2500	2800	4650	4950
<b>Machine weight conveyor table (kg)</b>	-		3000	3300	2700	3000	-	
<b>Electric power supply (1kW electrospindle)</b>	400V 50/60Hz 14kW		400V 50/60Hz 14kW		400V 50/60Hz 14kW		400V 50/60Hz 14kW	
<b>Electric power supply (3kW electrospindle)</b>	400V 50/60Hz 17kW		400V 50/60Hz 17kW		400V 50/60Hz 17kW		400V 50/60Hz 17kW	
<b>Pneumatic power supply</b>	8/10 bar 800 l/min		8/10 bar 800 l/min		8/10 bar 800 l/min		10 bar 600l/min	

\* Optional

\*\*If the Seeker System PRO is provided, the height is 3250 mm

\*\*\*If the Seeker System PRO is provided, the height is 3360 mm

Weights and measures are indicative parameters

The technical specifications indicated in the table may be updated and modified as a result of any improvements and technology developments



HEAD OFFICE  
**Elitron IPM srl**  
 Viale I Maggio, 42  
 63813 Monte Urano (FM) Italy  
 ☎ +39 0734 842221  
 elitron@elitron.com  
[www.elitron.com](http://www.elitron.com)

USA BRANCH  
**Elitron America Inc.**  
 1650 Oakbrook Dr. Ste 425  
 Norcross, GA 30093 USA  
 ☎ +1 (844) 354-8766